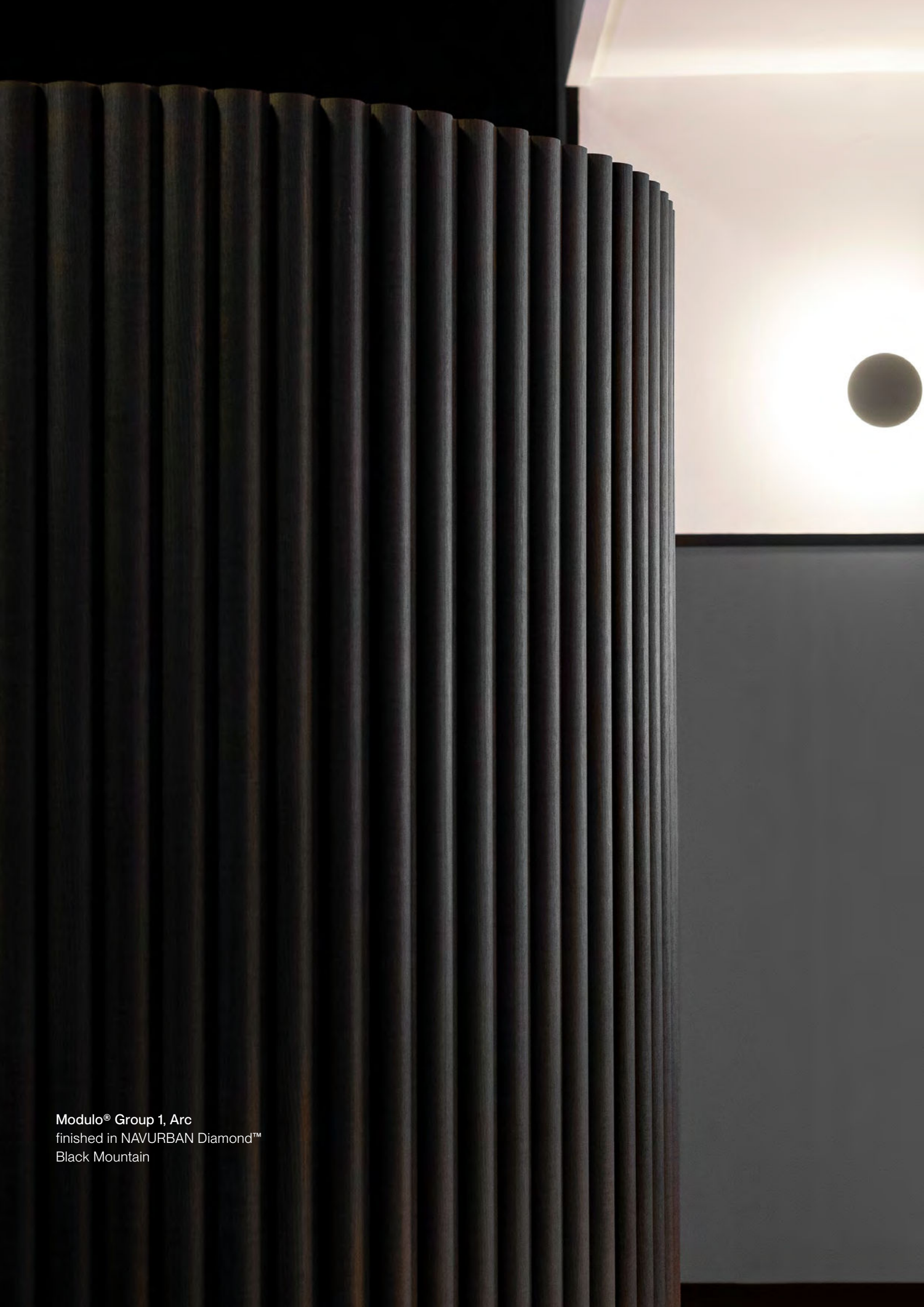


Install Guide

# Modulo<sup>®</sup> Group 1

The prefinished, tongue and groove lining system for high occupancy or fire-rated environments.



A photograph of a curved wall composed of numerous dark, vertically-slatted panels. The wall is set against a light-colored wall with a recessed ceiling light fixture and a circular light fixture. The lighting is dramatic, highlighting the texture of the slats.

Modulo® Group 1, Arc  
finished in NAVURBAN Diamond™  
Black Mountain

# Modulo® Group 1 Installation Guide

## Suitable Applications

Modulo® Group 1 is manufactured from aluminium and is suitable for internal ceiling, walls and curved applications. It is not warranted for use in external areas.

Modulo® Group 1 is designed for use in areas where a fire rating of Group 1 or Group 2 is required. For all other applications, Modulo® MR may be a more suitable solution.

## Before you begin

---

### Fixing

- The Modulo® Group 1 sections are designed to be screw fixed through each tongue where it intersects the furring channel or battens on the prepared wall or ceiling.
- Modulo® Group 1 is suitable for self-drilling screws, however pre-drilling may be required depending on the specific fastener. An 8-gauge countersunk screw should be used for fixing, and located on the panels using the centring groove on the tongue. A polyurethane adhesive is to be applied to the furring channel prior to Modulo® being fitted (Fig. 1).

### Curving

- Modulo® Group 1 can be installed on both internal and external radius up to 500mm using the notches on the back of the profile to gently bend the profile.
- For curves tighter than 500mm radius, a clamp can be used to manipulate the profile along engineered crease lines.

### Cutting

- The Modulo® Group 1 sections can be cut to size using a panel saw or track saw with aluminium blade.
- Flats on the back of the profile allow for adhesive fixing when profiles require cutting to fit the space.

### Profile Weights

For profile weights, please refer to the Profile Spec Sheets available on our website when calculating the load capabilities found at [screenwood.com.au/range/modulo-group-1/](https://screenwood.com.au/range/modulo-group-1/) or contact our team for information.

### Detailing

Screenwood recommends generic aluminium profiles (powdercoated in a suitable finish colour) for top and bottom detailing.

Find examples in our Technical Gallery at [screenwood.com.au/technical-gallery/](https://screenwood.com.au/technical-gallery/).

# Modulo® Group 1 Installation Guide

## Important notes for out-of-weather applications

---

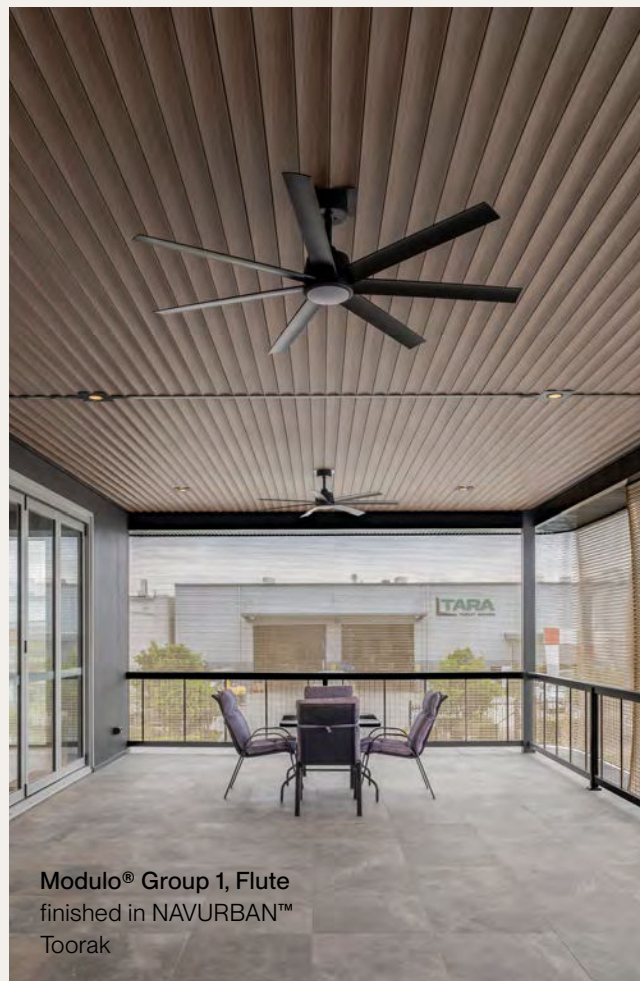
Due to aluminium having a high coefficient of thermal expansion, clearances need to be allowed as follows:

- Pilot holes need to be predrilled with 1mm of clearance on all sides of the fasteners. Fasteners should not be overtightened so as to allow for slight movement.
- 10mm express joints should be incorporated between bays and around the perimeter, we do not recommend butt joining of lengths.

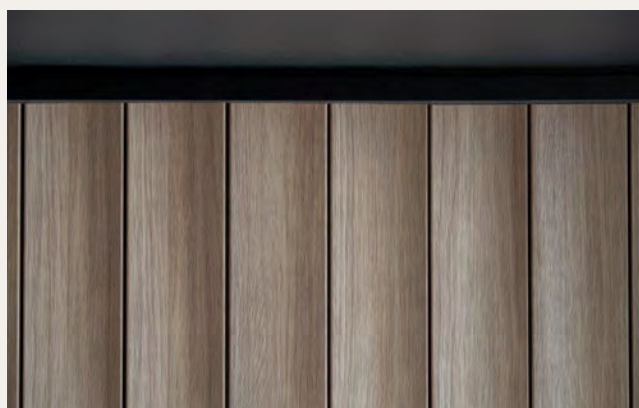
Aluminium profiles are susceptible to galvanic corrosion. When installing in out-of-weather environments we recommend the following:

- T304 grade stainless steel fasteners (non-coastal environments)
- 316 grade stainless steel fasteners (coastal environments)
- Non-conductive isolating washers are recommended to be installed between surfaces where the aluminium is in direct contact with other metals.

Please refer to the Modulo® Cleaning and Maintenance Guide and Modulo® Group 1 Warranty to determine if this product is suitable for your intended application.



Modulo® Group 1, Flute  
finished in NAVURBAN™  
Toorak



# Flat Wall Installation

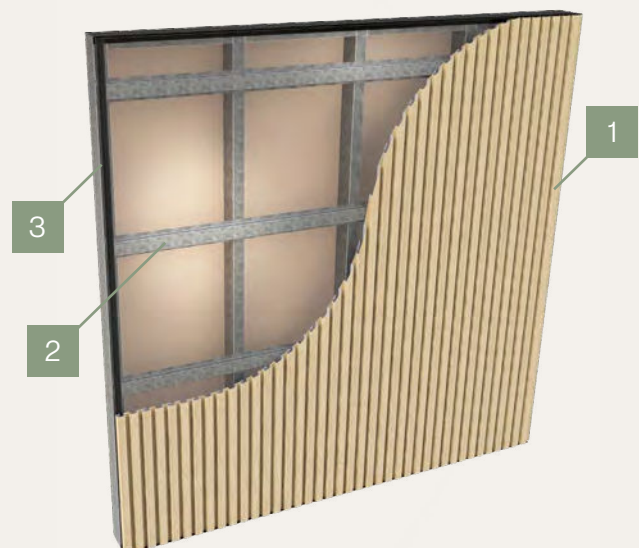
## Modulo® Group 1

### Recommended Installation

You will need:

- Modulo® Group 1 in your specified lengths including wastage
- Top hat, furring channel or battens
- Aluminium trims for top and bottom edges (if required)
- Starter bead
- Corner trim
- Measuring device
- Level
- Panel saw or track saw with a suitable aluminium blade
- 6g countersunk screws
- Clamp for radius tighter than 500mm
- High bond tape
- Silicone adhesive

Figure 1. Cross section of Modulo® Group 1 wall installation



- 1 Modulo® Group 1
- 2 Top hat
- 3 Aluminium trim (if required)

# Simple Steps for Flat Wall Installation

## Step 1

Ensure the prepared wall surface is true and plumb. Ensure protective packaging is removed from Modulo® Group 1 before installing.

## Step 2

Fix top hat or battens at the top and bottom of the wall at the heights where the panels are to be installed. (See fig.2)

## Step 3

In addition to top and bottom, install additional top hat parallel to the top and bottom channels at a maximum distance of 600mm. (See fig.2)

## Step 4

If installing top and bottom aluminium trims, install the bottom trim allowing for the desired shadow line spacing (if applicable). (See fig.2)

## Step 5

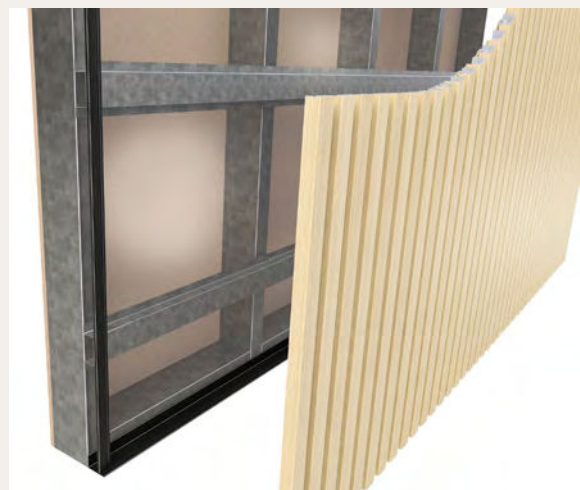
Install the starter bead to the top hat ensuring it is plumb. (See fig.2)

Figure 2. Wall preparation with top hat at 600mm apart and start trim



- 1 Spacing for top hat or battens
- 2 Top hat
- 3 Start trim
- 4 Aluminium trim (optional)

Figure 3. Close up of wall with aluminium angle



# Simple Steps for Flat Wall Installation

## Step 6

Install the starter bead to the furring channel ensuring it is plumb. (See fig. 4)

## Step 7

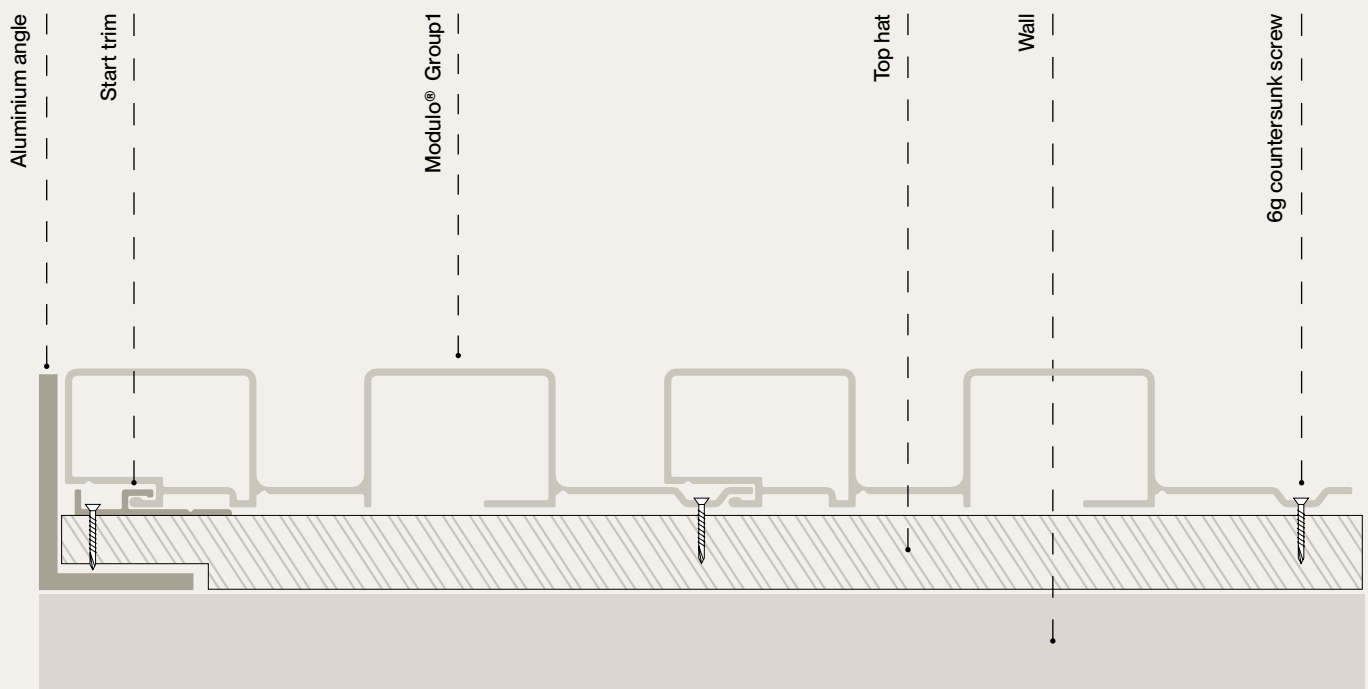
Screw fix each section through each tongue where it intersects the furring channel or battens. Pre-drilling may be required.

Figure 4. Installing first Modulo® Group 1 panel



- 1 Modulo® Group 1 lining
- 2 Top hat
- 3 Start trim (optional)
- 4 Aluminium trim (if required)

Figure 5. Section view of concealed screw installation of Modulo® Group 1



# Simple Steps for Flat Wall Installation

## Step 8

Continue fixing each section.

## Step 9

At the end of the run, the last piece may need to be cut at a specific width using a panel saw or track saw with an appropriate aluminium blade and safety measures in place. Use flats designed into the extrusion for the use of high bond tapes (such as 3M VHB 4910) & silicone adhesives. (See Fig. 7)

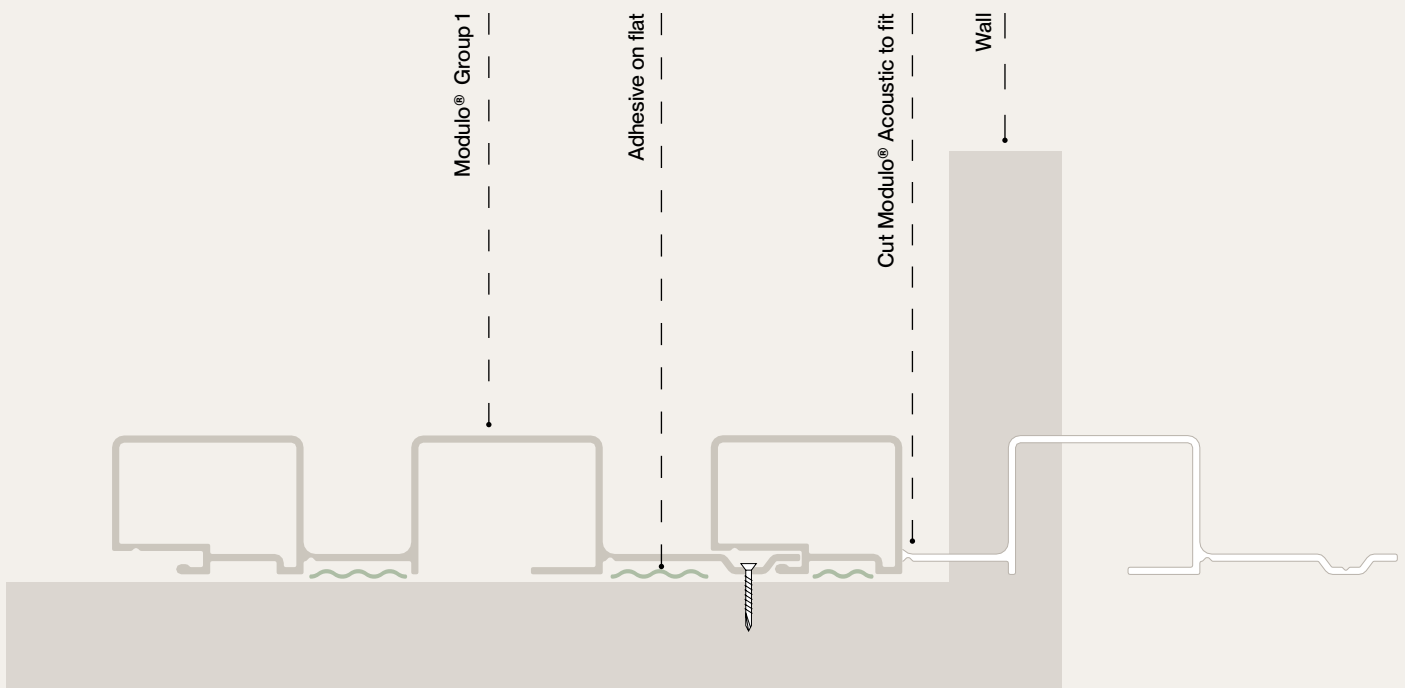
## Step 10

Wipe down with a clean damp cloth.

Figure 6. Continue fixing Modulo® Group 1

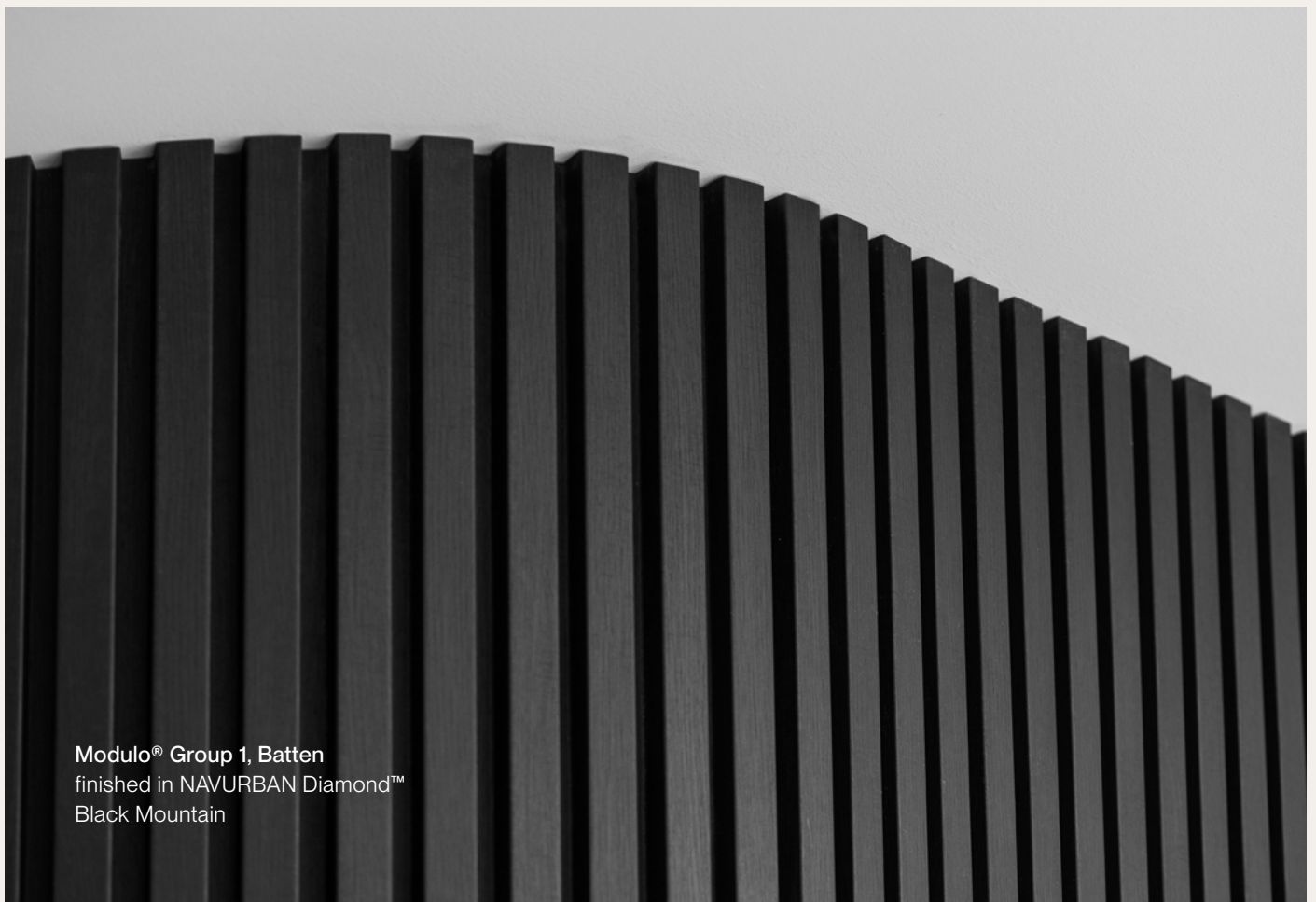


Figure 7. Section view of cuts and adhesive example



# Simple Steps for Curved Wall Installation

For curved wall installation, follow steps 1-9 for Flat Wall Installation (pages 4-7).



Modulo® Group 1, Batten  
finished in NAVURBAN Diamond™  
Black Mountain

# Ceiling Installation

## Modulo® Group 1

### Recommended Ceiling Installation Process

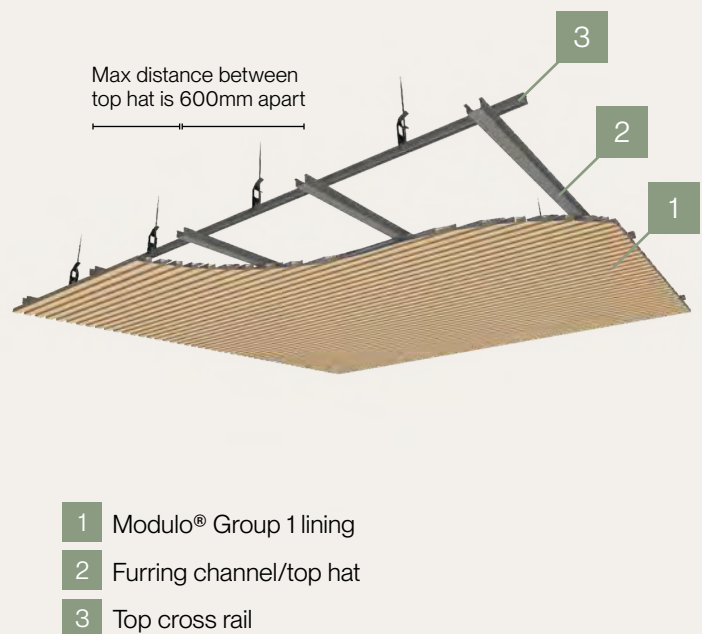
You will need:

- Modulo® Group 1 in your specified lengths including wastage
- Top hat, furring channel or battens
- Aluminium trims for top and bottom edges
- Starter bead
- Level
- Measuring device
- Panel saw or track saw with aluminium blade
- Screws
- Construction adhesive

### Ceiling preparation

1. If installing on a suspended ceiling the Modulo® Group 1 panels are installed in the same direction as the TCR and fixed off where they intersect the furring channel. For direct fix ceilings, fix the top hat in the opposite direction to the Modulo® Group 1 panels.
2. The furring channel or top hat should be placed within 200mm of the walls and at a maximum of 600mm centres.
3. A shadowline angle is a common detail used around the perimeter and this should be fixed to the wall at the nominated height prior to installing the panels.
4. Ensure the ceiling is true and the variation is no greater than 3mm per metre.

Figure 8. Typical suspended ceiling detail



# Simple Steps for Ceiling Installation

## Step 1

Fix the start trim at the position where the first Modulo® Group 1 profile is to be installed.

## Step 2

Slot the groove of the first board into the start trim and fix through the tongue using an appropriate 6g screw.

Screw fix each section through each tongue where it intersects the top hat. Pre-drilling may be required. Use flats designed into the extrusion for the use of high bond tapes (such as 3M VHB 4910) and silicone adhesives.

## Step 3

Continue fixing the Modulo® Group 1 panels across the ceiling.

## Step 4

The final panel will need to be fixed using VHB tape and / or silicone adhesive on the nearest flat on the back of the extrusion. It is also recommended that a bead of adhesive is used in the final tongue and groove channel for maximum adhesion.

## Step 5

Wipe down with a clean, damp cloth.

Figure 9. Section view with cuts and adhesive

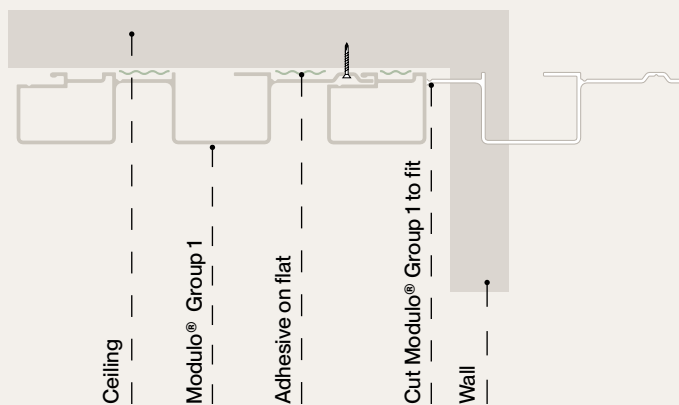
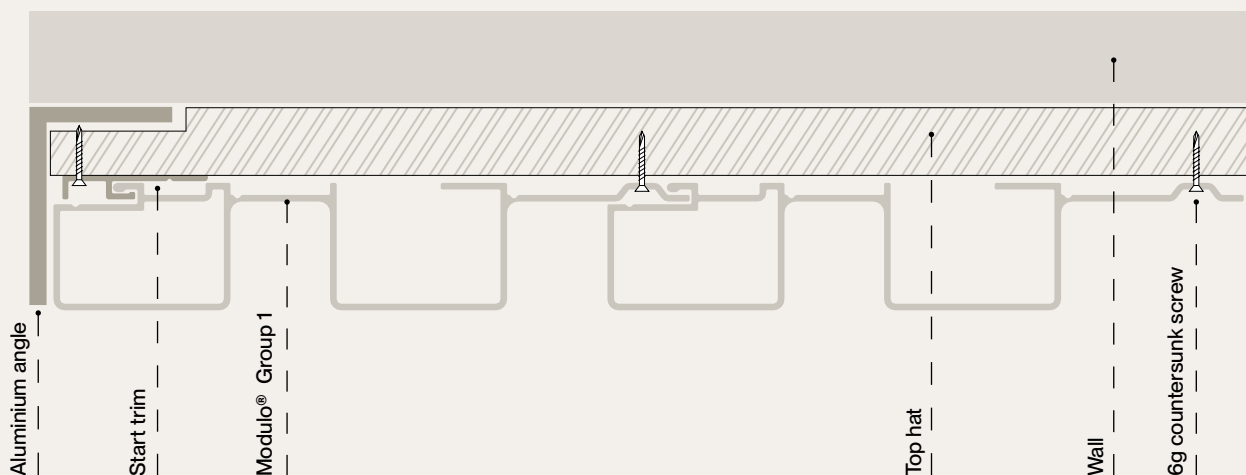


Figure 10. Suspended ceiling cross section



# Finishing Options

## Modulo® Group 1

Modulo® Group 1 can be finished in a variety of ways including aluminium trims and matching Stix® battens.

---

### Screenwood Starter Bead

- For a professional finish, use Screenwood starter bead for walls. Select the custom starter bead to match the profile you are using.

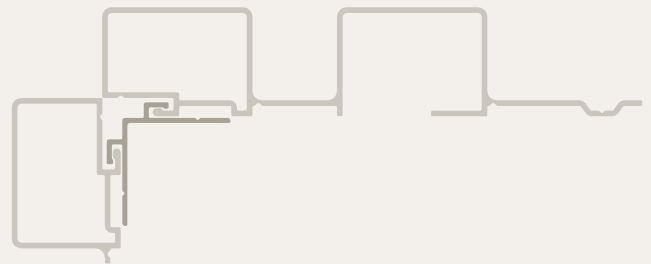
Figure 15. Starter bead for Modulo® Group 1,  
Batten profile



### Screenwood Corner Trim

- For a seamless corner finish with both vertical and horizontal applications, use a Screenwood corner trim.

Figure 16. Corner trim for Modulo® Group 1,  
Batten profile



---

## Stix® by Screenwood

Stix® are loose decorative timber battens, available in a range of sizes and profiles and prefinished in NAVURBAN™ finishes. Stix® integrates seamlessly with our Modulo®, Soundlina® and Panels ranges, or can be used as standalone decorative battens. To learn more visit <https://screenwood.com.au/range/stix/>.

Note: Stix is not available in a Group 1 fire rating. Please ensure suitability for use in your project.



# Care and Maintenance Guide

## Recommended cleaning method

NAVURBAN™ surfaces are easy to clean using a damp cloth and mild soap and warm water or non-abrasive wood cleaning products.

- Do not use abrasive cleaners, pads, or harsh solvents.
- Ensure to wipe in the direction of the grain structure for best results.

We recommend you test on a small area or sample prior to applying to surface.

- Do not allow solvent, acetone or trichloroethylene to come in contact with the surface.
- Accidental spills, splatters or over sprays should be wiped off immediately with a soft cloth and mild soap.
- Alcohol, ammonia and other light solvents may be used for tougher stains.

If in doubt about a particular cleaner or detergent, please reach out to your designated representative to assist with suitability.

A complete cleaning and maintenance guide can be found at <https://screenwood.com.au/resources/>.





We're ready to help.

**Screenwood Australia**

432 The Boulevard  
Kirrawee NSW 2232  
Australia

**+61 2 9521 7200**

**hello@screenwood.com.au**

**Be inspired**

Explore our product innovations and  
get inspired at **screenwood.com.au**

**Acknowledgement of Country**

In the spirit of reconciliation, we acknowledge the Traditional Custodians of Country throughout Australia and their connections to land, sea and community. We pay our respect to their Elders past and present and extend that respect to all Aboriginal and Torres Strait Islander peoples today.

**Screenwood for all**

Our products are for everyone, and so is our workplace. We believe in constantly building a diverse and inclusive culture for a more equitable world.

**Disclaimer** All care is taken in the preparation of the information and published materials produced by Screenwood. However, Screenwood does not make any representations or give any warranties about its accuracy, reliability, completeness or suitability for any particular purpose.